

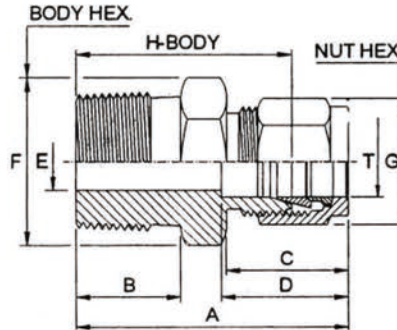

## SPMC Male Connector



Size OD-Thread	Part Number	A	B	C	D	E Min	F A/F	G A/F	H Body
1/8-1/8	SPMC22	30.3	9.5	15.3	12.7	2.4	11	11	23.8
1/4-1/4	SPMC44	38	14	17.7	15.3	4.8	14	14	30.5
1/4-3/8	SPMC46	38.5	14	17.7	15.3	4.8	17	14	31
1/4-1/2	SPMC48	44.5	19	17.7	15.3	4.8	22	14	36.5
3/8-1/4	SPMC64	40.5	14	19.3	16.8	7.1	16	17	32.5
3/8-3/8	SPMC66	40.5	14	19.3	16.8	7.1	17	17	32.5
3/8-1/2	SPMC68	46	19	19.3	16.8	7.1	22	17	38.8
1/2-3/8	SPMC86	43.4	14	22	22.9	10.4	20.5	22	33.3
1/2-1/2	SPMC88	49	19	22	22.9	10.4	22	22	38.9
1/2-3/4	SPMC812	49.2	19	22	22.9	10.4	27	22	40.3
5/8-1/2	SPMC108	49.2	19	22	24.4	11.9	24	25	39
3/4-1/2	SPMC128	50.5	19	22	24.4	11.9	27	28.5	40.5
3/4-3/4	SPMC1212	50.5	19	22	24.4	15.8	27	28.5	40.5
3/4-1	SPMC1216	57	23.8	22	24.4	15.8	36	28.5	47
1-1	SPMC1616	62.3	23.8	26.5	31.2	22.2	36	38.1	50

## SPFC Female Connector

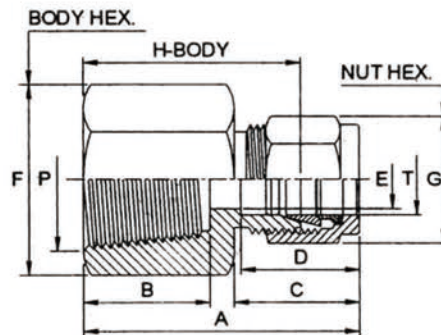

Size OD-Thread	Part Number	A	B	C	D	E Min	F A/F	G A/F	H Body
1/4-1/8	SPFC42	31.7	9.5	17.7	15.3	4.8	14	14	23.8
1/4-1/4	SPFC44	36.5	14	17.7	15.3	4.8	19	14	28.6
3/8-3/8	SPFC66	39.7	14	19.3	16.8	7.1	22	17	31.8
1/2-1/2	SPFC88	46.8	19	22	22.9	10.4	27	22	36.5
3/4-1/2	SPFC128	46.5	19	22	24.4	15.8	27	28.5	36.5
3/4-3/4	SPFC1212	48.4	19	22	24.4	15.8	32	28.5	38.1
1-1	SPFC1616	61.9	23.8	26.5	31.2	22.2	42	38.1	50